



Loading Meter also available with DN 80 (3") size, 90 m<sup>3</sup>/h

## Oval Wheel Meter OV 800

- only two moving parts
- excellent metrological characteristics
- no inlet or outlet section required
- robust design
- wear-resistant proximity switches with NAMUR power supply  
acc. to DIN EN 60947-5-6 for simple and reliable signal processing
- optional with installed Pt 100 for electronic temperature compensation

Sensors



### Measuring principle

Oval wheel meters are positive displacement flow meters. The measuring element consists of two precision oval wheels, driven by the fluid. Each revolution of the oval wheels displaces a precisely known volume of liquid through the meter.

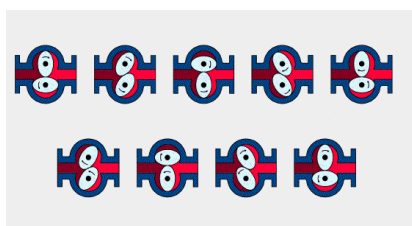

The number of revolutions therefore is directly proportional to the measured volume.

Loading meter type OV 800 (1) in a loading skid for lubricating oil with strainer (2) and centrifugal gas separator (3)



### Technical Data

<b>accuracy</b>	± 0,3% to ± 0,1% (depending from flow range and liquid)
<b>liquid temperature</b>	-10 °C bis +60 °C
<b>nominal size</b>	DN 80 (3")
<b>nominal pressure</b>	PN 16 ANSI 150
<b>process connection</b>	DIN EN 1092-1, ANSI 150 RF
<b>overall length</b>	550 mm
<b>outputs</b>	NAMUR pulses (4 pulses per liter)
<b>safety class</b>	II 2 G EEx ia II C T6
<b>degree of protection</b>	IP 67
<b>EG declaration of conformity</b>	NAMUR DIN EN 60947-5-6 ATEX 100; Pressure Equipment Directive Approvals for custody transfer available (Z 5.241 / 01.55)

### Measuring range

<b>Measuring range</b>	40 to 1500 l/min viscosity related
<b>Viscosity ranges</b>	0,3 to 17 mPas ; 3,5 to 120 mPas

# The arguments for Oval Wheel Meter Series OV

... based on the proven Oval Wheel Meter principle

- direct measurement of volume and flowrate
- approval for custody transfer
- no inlet or outlet section required
- robust design
- long meter life and reliability
- high long term stability
- highest accuracy/repeatability
- easy installation
- no influence of flow profile
- non-sensitive for vibration, pulsation, viscosity and pressure changes

## Main dimensions

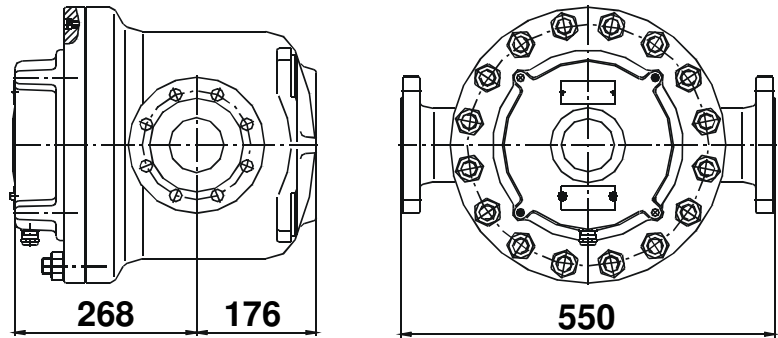

Dimensions in mm

## Pressure loss

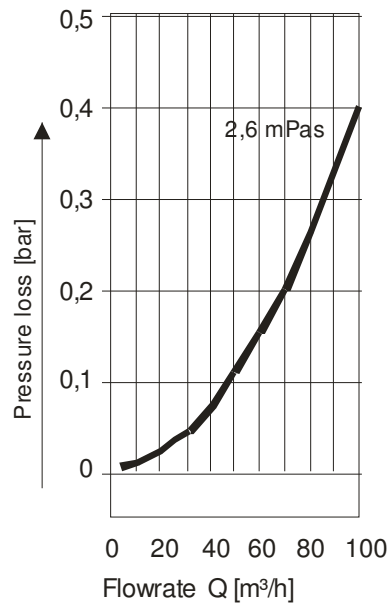

## Connection terminal pulse pick-up type AG54

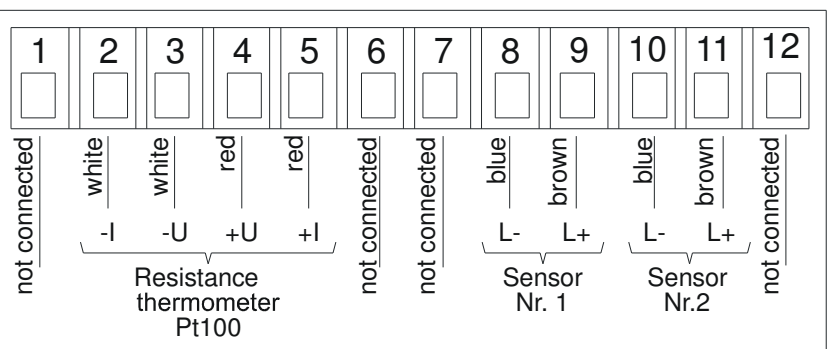

... combined with a modern pulse pick-up AG 54

- wear-resistant sensor
- inductive pulse pick-up acc. NAMUR
- for hazardous area
- dual pulse pick-up
- bidirectional metering possible
- phase shifted pulses for return flow detection

Subject to changes without notice